

# Platypus Controller Quick Guide USA

<i>About the Platypus Controller</i>	2-3
<i>Platypus Controller Dimensions</i>	4-5
<i>Installing the Platypus Controller</i>	6
<i>Temperature Sensor Installation Options</i>	7
<i>Temperature Sensor Specifications</i>	8
<i>Engine Run Times</i>	9
<i>Warranty</i>	10

Distributed by  
Platypus USA



**PLATYPUS<sup>®</sup>  
CONTROLLER**

and



**PLATYPUS<sup>®</sup>  
SPRINKLER**

*The Sensible Ember Protection System*

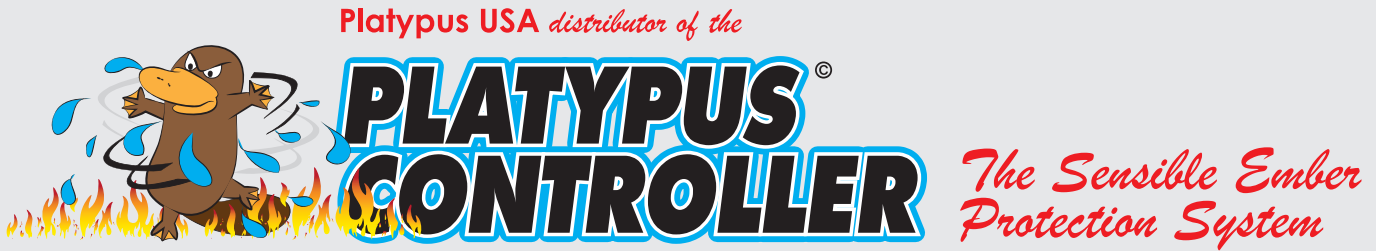

## About the Platypus Controller

The Platypus Controller measures ambient air temperature to automatically activate compatible equipment that supplies water to the sprinkler system. The temperature that activates the system is set by the user up to a maximum of 140°F.

When the ambient air temperature rises above the set point, the system becomes active. The system will run for an amount of time which is set by the user up to a maximum of 60 minutes.

After the run time has expired, the system pauses for an amount of time, also set by the user, up to a maximum of 60 minutes. The ambient air temperature is measured again, if it is still above the set point the controller will run the system again.

This cycle is repeated until the ambient air temperature falls 35°F to 40°F below the set point. During these cycles the controller will send SMS information\* to the stored numbers advising the status of the system.

The EVAC Button feature allows the user to turn the system on to run for cycle times up to 60 minutes when leaving the property, after the set time has expired the controller will go back into Auto Mode.

## Automate your wildfire protection system



### Key Features:

- LCD touch screen display
- Back up power from engine battery
- Run and pause cycles extend available water and fuel
- Mobile phone connectivity\*
- Automatic control of diesel\*\* and or electric pump
- Step up control of compatible variable speed controllers
- User adjustable trigger temperature and run times
- Automatic or manual operation
- EVAC Button
- Maintains float charge in engine battery
- Multi user
- Password protected
- Low fuel sensing (on compatible fuel tanks)

- IP66 wall mount enclosure
- RCM certification
- 149°F Failsafe
- Control of 12vdc solenoids with pulsed coil
- No annual fees, choose your own network provider
- 12 month limited warranty

### Options

- High gain pole mount antenna
- Additional external temp sensor
- Solar charge kit
- AC power adapter
- Flow switch
- Tank float switch

Email [info@platypussprinklerusa.com](mailto:info@platypussprinklerusa.com) or visit [www.platypussprinklerusa.com](http://www.platypussprinklerusa.com)

\*If SIM card has been installed by end user.

\*\*Engine must have a compatible fuel stop solenoid and electrical system.

## Platypus Controller dimensions

- back and side view

Shown with optional enclosure mounted temperature sensor and antenna.

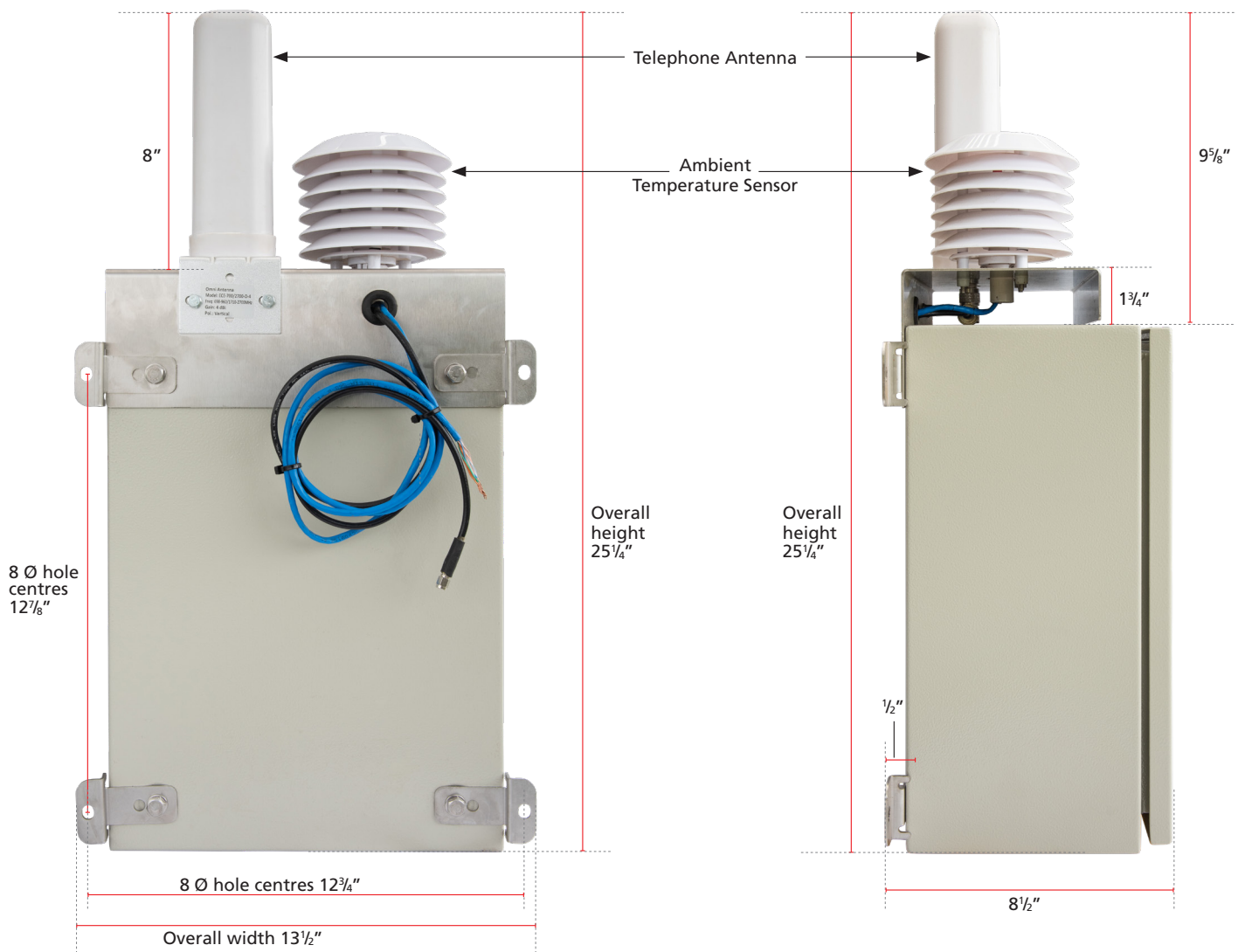

**NOTE: Dimensions shown are to be used as a guide only.**



*The Sensible Ember  
Protection System*

## Platypus Controller dimensions - top and bottom view

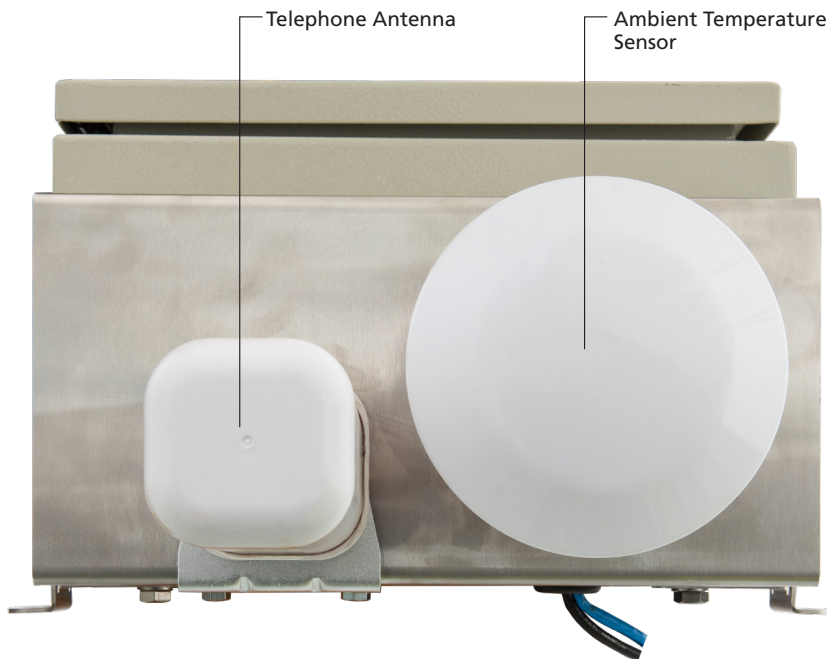

- Total weight 29lbs (pounds)
- The IP rating of the enclosure is IP66
- The Platypus Controller has been tested and complies with AS/NZS 60950.1:2015, AS/CA S042.1:2015 and AS/CA S042.4:2015. Test date, 28 September, 2016



## Installing the Platypus Controller

Figure 1.

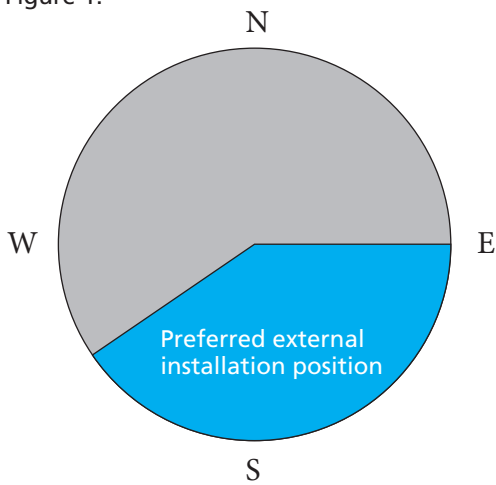

Figure 1.

- When installing the Platypus Sprinkler Controller to the exterior of a building, the Platypus Sprinkler Controller should be installed on a surface that is not exposed to the sun in the later part of the day.
- The area marked in blue on the compass in Figure 1 shows the preferred location of the Platypus Sprinkler Controller.
- This is to ensure the reading from the temperature sensor mounted at the top of the Platypus Controller enclosure will not give a false indication due to radiant heat.

**Remote Temperature Sensor Location:**

The Remote Temperature Sensor should ideally be positioned in the path that fire is most likely to approach from.

Maximum CAT5 cable length 300 feet.



## Platypus External Temperature Sensor Assembly Options

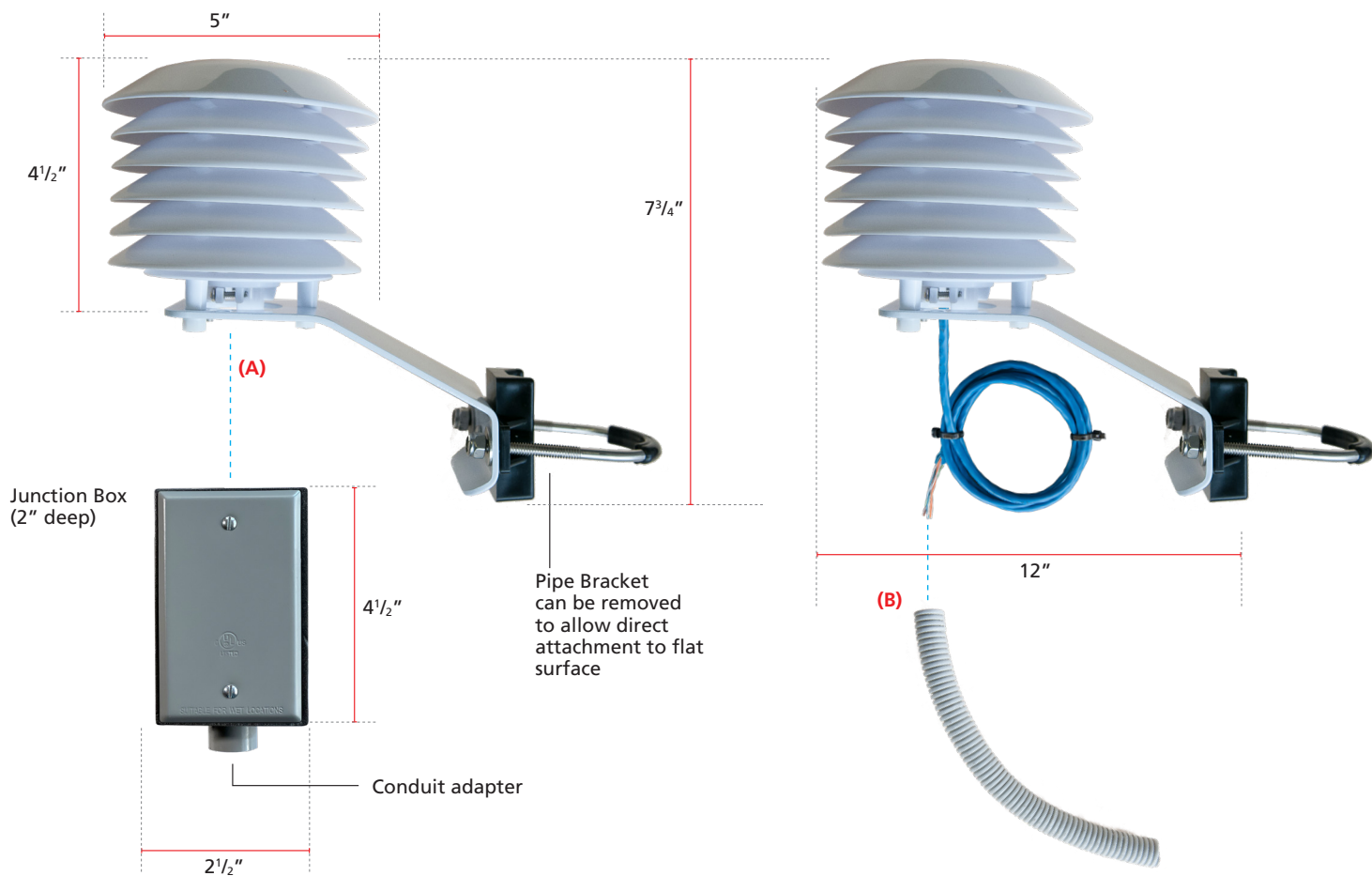

Note: Junction box can be fitted directly into bottom of sensor (A) or fixed at another point using 20mm flexible conduit (B).

External Temperature Sensor is supplied fitted with Thermistor and 3 feet of CAT5 Cable.

Maximum CAT5 Cable Length 300 feet.

## Platypus External Temperature Sensor Specifications







## Engine Run Times

**Engine run times using Platypus Controller  
(Diesel engines only with standard fuel tank)**

	<b>5mins on / 10mins off</b>	<b>10mins on / 10mins off</b>	<b>10mins on / 5mins off</b>
<b>Yanmar L48</b>	7.30 Hours	4.9 Hours	3.6 Hours
<b>Yanmar L70</b>	7.00 Hours	4.7 Hours	3.5 Hours
<b>Yanmar L100</b>	7.90 Hours	5.3 Hours	3.9 Hours
<b>Kohler KD350</b>	9.10 Hours	6.1 Hours	4.5 Hours
<b>Hatz 1D81</b>	9.75 Hours	6.5 Hours	4.8 Hours

Run / Pause cycle times are set by the user / installer up to a maximum of 60 minutes.

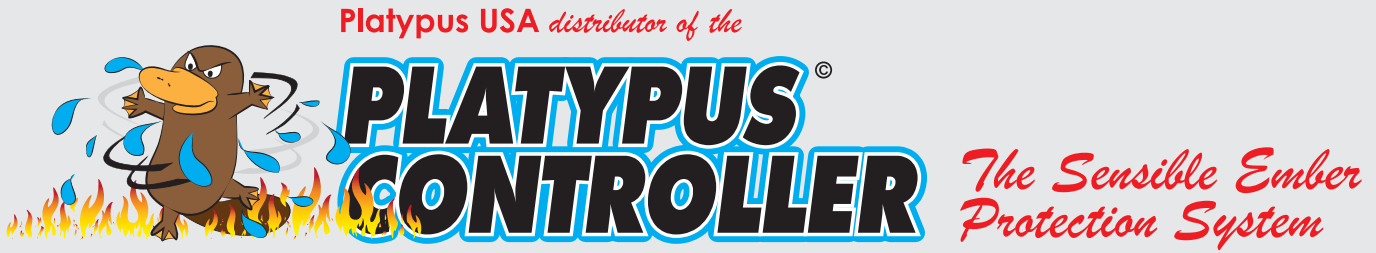

## *Product Warranty*

12 month limited warranty.

For Warranty & Service Inquiries Contact Platypus USA [sales@platypussprinklerusa.com](mailto:sales@platypussprinklerusa.com)

Manufactured in Australia by Platypus Fire Pty Ltd [info@platypussprinkler.com.au](mailto:info@platypussprinkler.com.au)